



UP TO 2,704 SQ FT AVAILABLE
FOR LEASE

RETAIL | HIGH QUALITY RETAIL UNIT LEASE OPPORTUNITY

EVERGREEN CROSSING 2

225 PAYNE BEND, SASKATOON

PROPERTY DETAILS

\$34.00

Asking Price, PSF

\$13.50*

2025 Est. Occupancy, PSF

Spring 2025

Availability

District:	Aspen Ridge
Zoning:	B4MX (<i>Integrated Commercial Mixed-Use</i>)
Parcel #:	204070845
Site Size:	2.52 Acres
Total Rentable Area:	± 1,352 – 2,704 SF
Parking:	Ample paved parking common to site
Heating/HVAC:	HVAC partial distribution in place

HIGHLIGHTS

- 2 High quality retail units for lease
- Total building size: 8,325 SF
- Located along McOrmond Rd & Payne Bend
- Current tenants: Affinity Credit Union, Affinity Insurance, JJ's Car Wash, Jimmy Johns and Chaiwala of London
- Available for Spring 2025



LEAD AGENT

SCOTT FRIESEN

President / Broker

1-306-934-3377

scott.friesen@cwsaskatoon.com

 **CUSHMAN & WAKEFIELD**
Saskatoon

SITE PLAN

FOR LEASE | 225 Payne Bend, Saskatoon SK

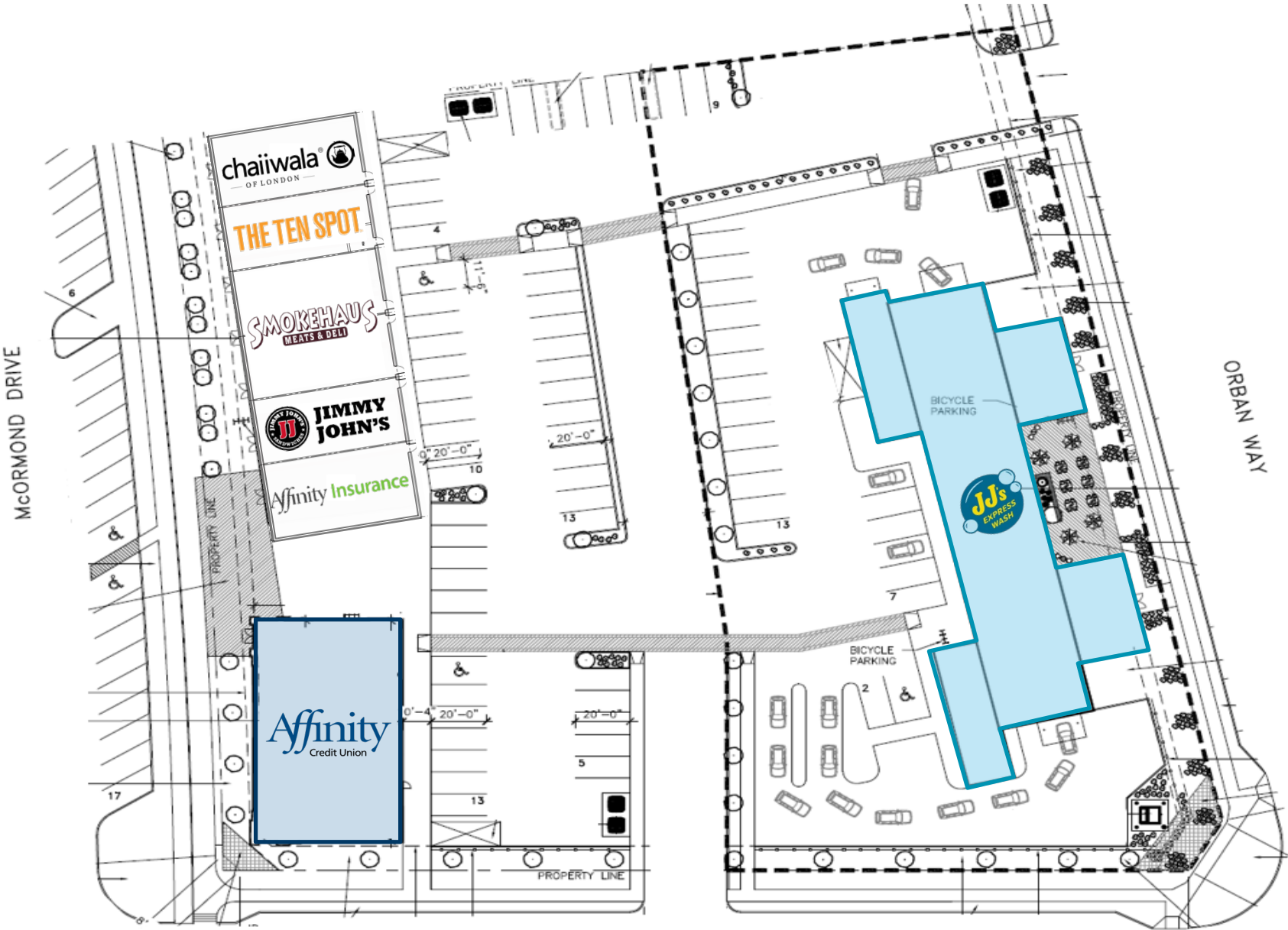

*Not to scale, not exactly as shown.

NEIGHBOURHOOD PROFILE

EVERGREEN | ASPEN RIDGE

FOR LEASE | 225 Payne Bend, Saskatoon SK

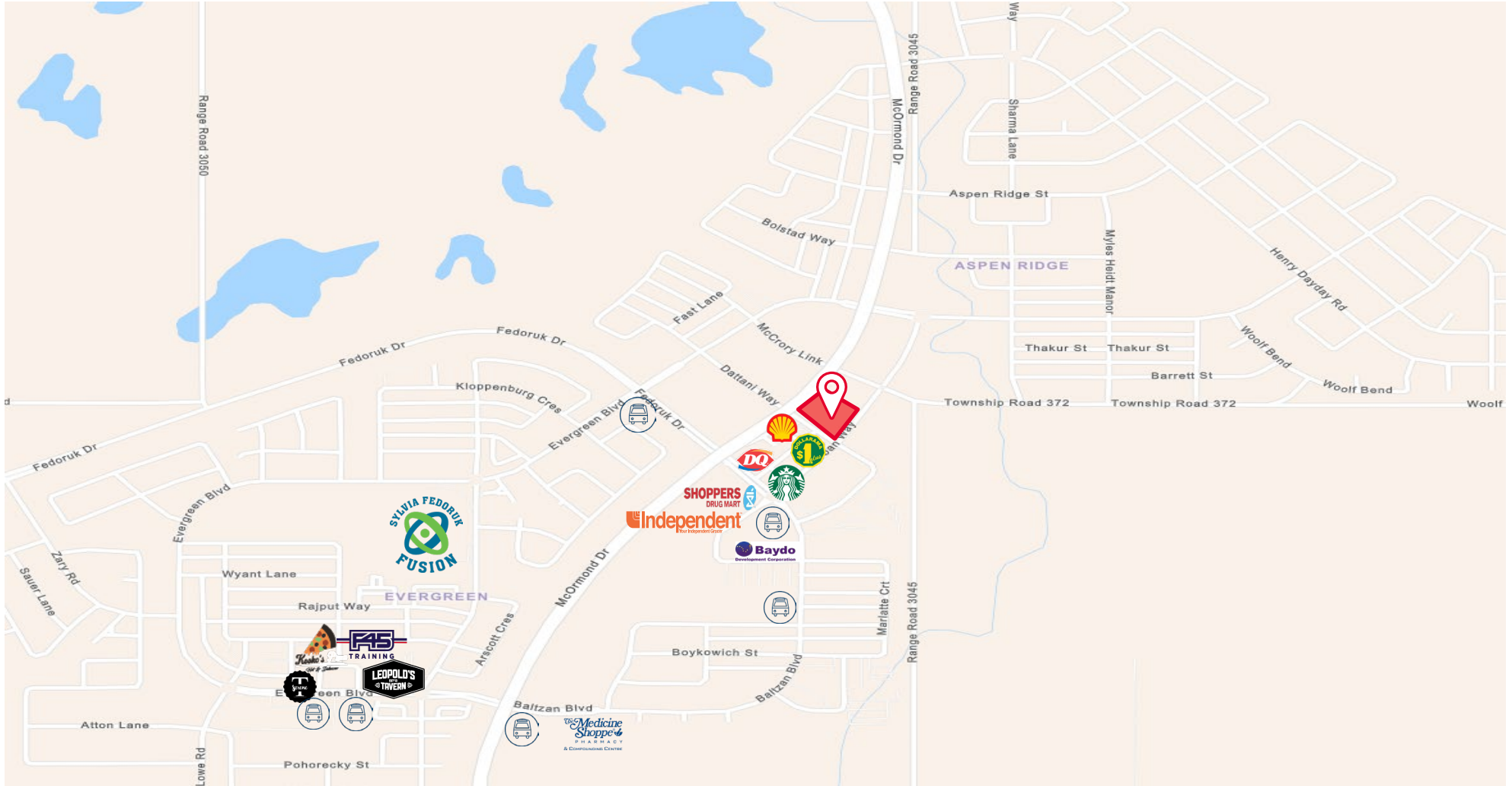

- Accommodates mixed-use development and blends residential, commercial and institutional activities into a District Village where residents can work, play, live and shop

- Proximity to 6 transit stations
- Access to new Chief Mistawasis Bridge
- 20 minutes to Downtown Saskatoon

LOCATION

FOR LEASE | 225 Payne Bend, Saskatoon SK



NORTH PRAIRIE TOWNHOMES

- Bellatowns in Evergreen
- 120 townhome units
 - 2-3 Bedroom & Garage

SEYMOUR PACIFIC

- Juniper gardens
- 162 rental units (1-2-3 Bedroom)
 - Phase 2: 116 rental units
- Evergreen Bend
- 204 rental units

BAYDO

- Multi-family
- Two - 6 storey Res Towers
- Baydo Plaza
 - 212 Rental Units
 - 1, 2 and 3 Bedrooms
- Phase 3-5 Under Construction
- Aspen Point
 - 38 Rental Units
- 1500 plus occupants within 2 block radius of Evergreen Crossing Shopping Centre

PHASE 1 FEATURES

- 2 Story Medical
- YXE Dental
- Pharmacy
- Dollarama
- Shell Gas Bar
- Dairy Queen Drive Thru
- Kumon
- Lucky's
- Joyous Pizza
- Starbucks
- Pet Value
- Cannabis Evergreen
- Mary Browns
- Subway





SCOTT FRIESEN

President / Broker

[1-306-934-3377](tel:1-306-934-3377)

scott.friesen@cwsaskatoon.com

MATT PRIEL

Senior Sales Associate

[1-306-261-2375](tel:1-306-261-2375)

matt.priel@cwsaskatoon.com

OFFICE

[1-306-934-3377](tel:1-306-934-3377)

info@cwsaskatoon.com

CUSHMAN & WAKEFIELD SASKATOON
A LOCAL FIRM WITH GLOBAL REACH

215-350 3rd Avenue North
Saskatoon, SK S7K 2J1
cushmanwakefieldsaskatoon.com

©2024 Cushman & Wakefield. All rights reserved. The information contained in this communication is strictly confidential. This information has been obtained from sources believed to be reliable but has not been verified. NO WARRANTY OR REPRESENTATION, EXPRESS OR IMPLIED, IS MADE AS TO THE CONDITION OF THE PROPERTY (OR PROPERTIES) REFERENCED HEREIN OR AS TO THE ACCURACY OR COMPLETENESS OF THE INFORMATION CONTAINED HEREIN, AND SAME IS SUBMITTED SUBJECT TO ERRORS, OMISSIONS, CHANGE OF PRICE, RENTAL OR OTHER CONDITIONS, WITHDRAWAL WITHOUT NOTICE, AND TO ANY SPECIAL LISTING CONDITIONS IMPOSED BY THE PROPERTY OWNER(S). ANY PROJECTIONS, OPINIONS OR ESTIMATES ARE SUBJECT TO UNCERTAINTY AND DO NOT SIGNIFY CURRENT OR FUTURE PROPERTY PERFORMANCE.