



UP TO 9,345 SQ FT  
**FOR LEASE**

**RETAIL** | EIGHT HIGH QUALITY COMMERCIAL RETAIL UNITS

# Kensington Union Retail

KENSINGTON, SASKATOON



## PROPERTY DETAILS

**\$33.00**

Asking Price, PSF

**\$14.00\***

2025 Est. Occupancy, PSF

**Fall/Winter 2026**

Availability

District:	Kensington
Zoning:	B1B ( <i>Neighborhood Commercial – Mixed Use</i> )
Parcel #:	203839993
Site Size:	0.62 Acres
Total Rentable Area:	± 1,040 SF – 9,345 SF
Parking:	Twenty-five (25) paved parking stalls common to site
Heating/HVAC:	HVAC units in place and connected

## HIGHLIGHTS

- Eight (8) high quality commercial retail units for lease
- Total building size: 9,345 SF
- Units can be combined for larger tenants



### LEAD AGENT

**MATT PRIEL**  
Senior Sales Associate

1-306-261-2375  
[matt.priel@cwsaskatoon.com](mailto:matt.priel@cwsaskatoon.com)



SITE PLAN

FOR LEASE | Kensington Union, Saskatoon SK

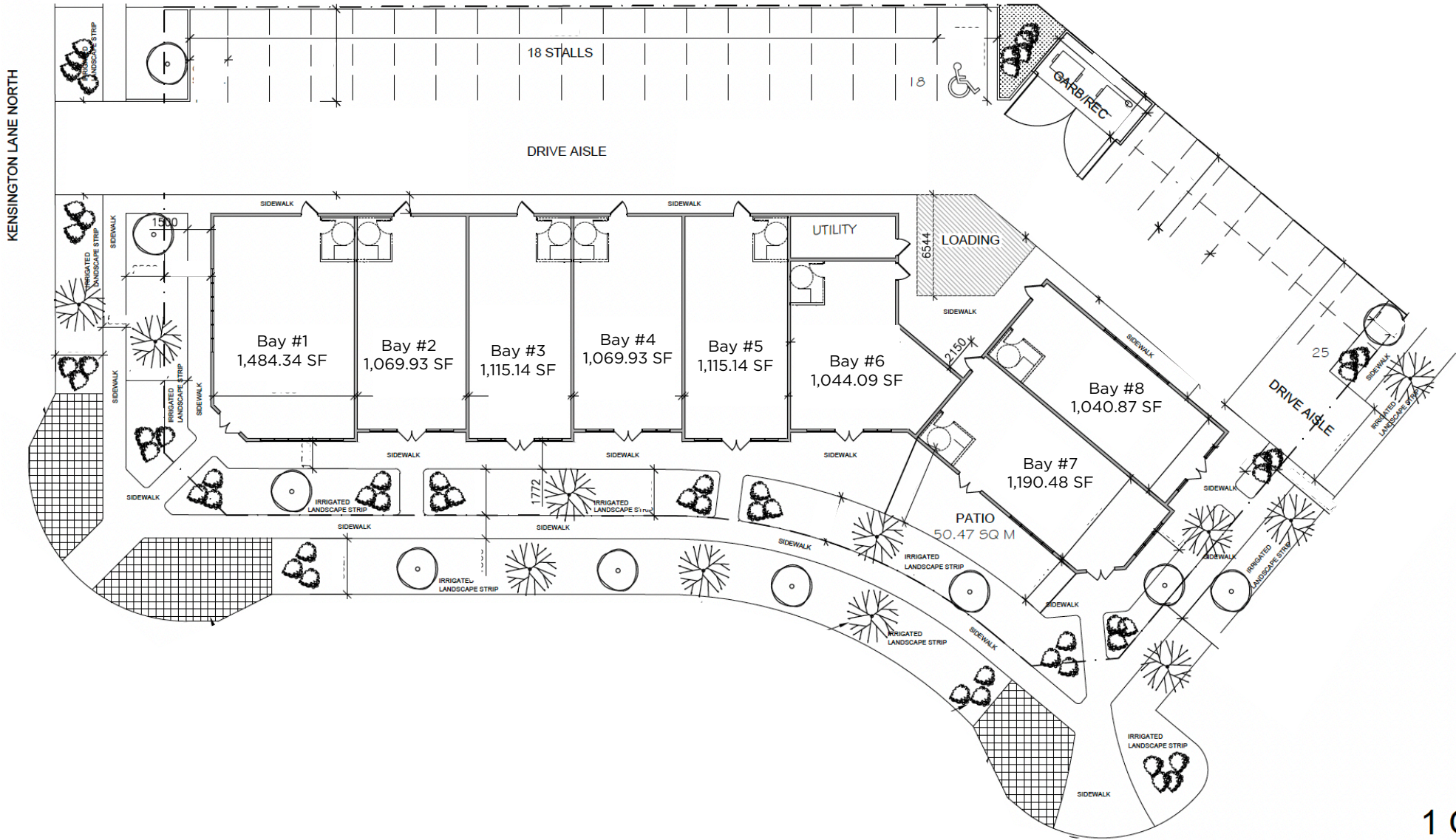

\*Not to scale, not exactly as shown.



# NEIGHBOURHOOD PROFILE

## KENSINGTON

FOR LEASE | Kensington Union, Saskatoon SK

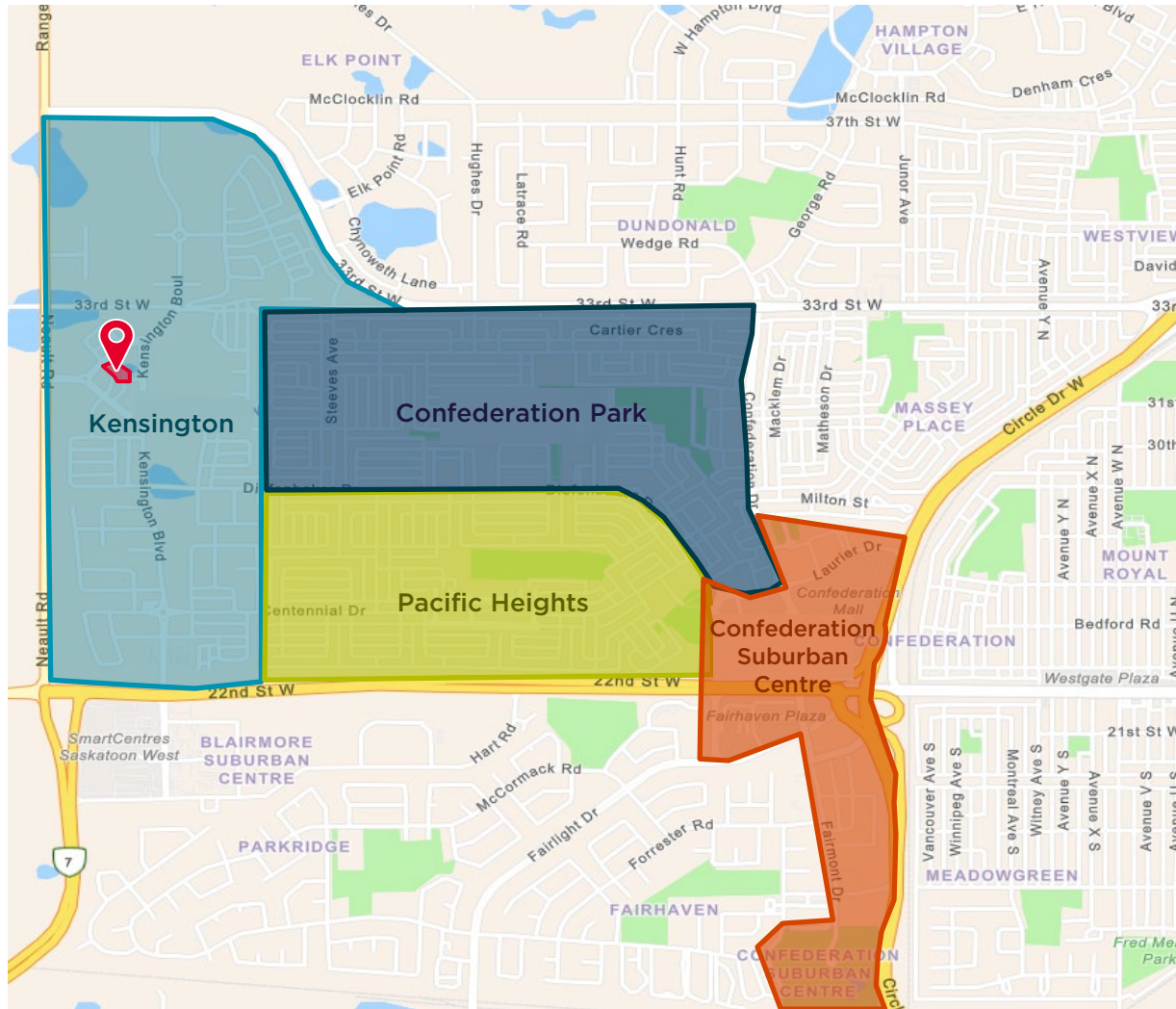

### OVERVIEW

Kensington is a rapidly growing, eco-focused community in west Saskatoon that has seen steady development since 2013. It features sustainable homes, greenways, sports fields, and the popular Village Square. The neighborhood offers a diverse mix of housing—from single-family homes to townhouses and apartment complexes. Continued residential and commercial growth will see Kensington reach a projected population of 8,300 by 2028, with multi-family developments playing a key role in its expansion.

- All lots contained throughout phase 1 - 6 of Kensington are sold
- Future school sites are located just off the core park, at the intersection of Nightingale Road and Kensington Boulevard
- 90 space daycare to be located on adjacent parcel T
- Across the street from Denis Mahoney Park

### LOCATION

- 15-minute drive to Downtown Saskatoon
- 15-minute drive to Saskatoon International Airport
- 16-minute drive to the North Industrial neighborhood



#### CURRENT POPULATION

4,818



#### PROJECTED POPULATION (2028)

8,300



#### AVERAGE HOUSEHOLD INCOME

\$95,697.00

**MATT PRIEL**

*Senior Sales Associate*

1-306-261-2375

[matt.priel@cwsaskatoon.com](mailto:matt.priel@cwsaskatoon.com)

**OFFICE**

1-306-934-3377

[info@cwsaskatoon.com](mailto:info@cwsaskatoon.com)

**CUSHMAN & WAKEFIELD SASKATOON**  
**A LOCAL FIRM WITH GLOBAL REACH**

215-350 3<sup>rd</sup> Avenue North  
Saskatoon, SK S7K 2J1

[cushmanwakefieldsaskatoon.com](http://cushmanwakefieldsaskatoon.com)

©2025 Cushman & Wakefield. All rights reserved. The information contained in this communication is strictly confidential. This information has been obtained from sources believed to be reliable but has not been verified. NO WARRANTY OR REPRESENTATION, EXPRESS OR IMPLIED, IS MADE AS TO THE CONDITION OF THE PROPERTY (OR PROPERTIES) REFERENCED HEREIN OR AS TO THE ACCURACY OR COMPLETENESS OF THE INFORMATION CONTAINED HEREIN, AND SAME IS SUBMITTED SUBJECT TO ERRORS, OMISSIONS, CHANGE OF PRICE, RENTAL OR OTHER CONDITIONS, WITHDRAWAL WITHOUT NOTICE, AND TO ANY SPECIAL LISTING CONDITIONS IMPOSED BY THE PROPERTY OWNER(S). ANY PROJECTIONS, OPINIONS OR ESTIMATES ARE SUBJECT TO UNCERTAINTY AND DO NOT SIGNIFY CURRENT OR FUTURE PROPERTY PERFORMANCE.