



±1,255 SQ FT AVAILABLE

FOR SUB LEASE

RETAIL | HIGH QUALITY RETAIL UNIT LEASE OPPORTUNITY

2712 Wentz Avenue

WENTZ AVE & 51ST STREET, SASKATOON

PROPERTY DETAILS

\$Negotiable

Asking Price, PSF

\$12.00

* 2025 Est. Occupancy, PSF

District: North Industrial

Zoning: IH (*Heavy Industrial*)

Parcel #: 118984506

Site Size: 2.59 Acres

Total Leasable Area: ± 1,255 SF

Parking: Ample paved parking common to site

HIGHLIGHTS

- High quality turnkey retail unit for sub lease
- Headlease expiry: July 31, 2029
- Available immediately
- Excellent transit access
- Total building size: ±6,200 SF
- Traffic Count 18,300 vehicles per day on 51st Street

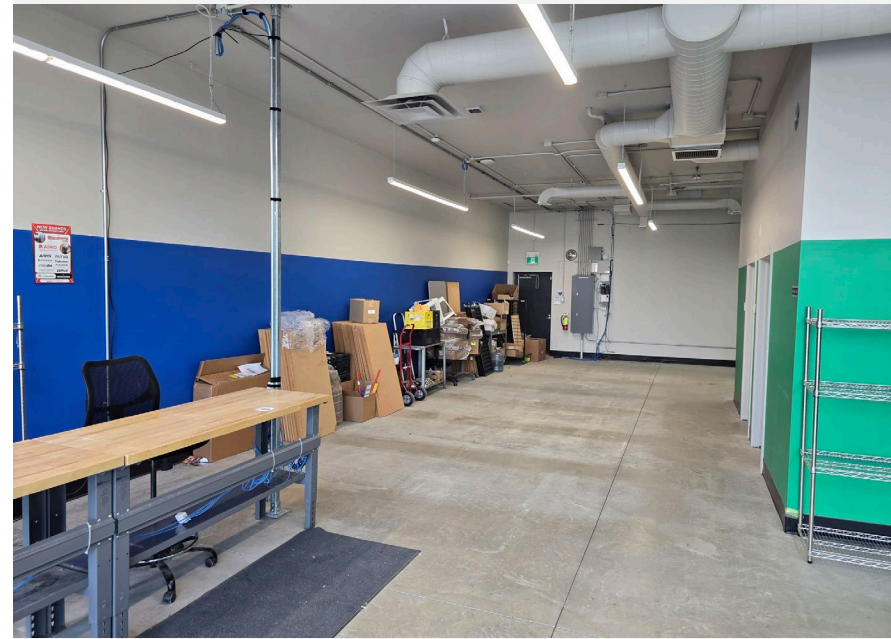

LEAD AGENT

SCOTT FRIESEN

President / Broker

[1-306-934-3377](tel:1-306-934-3377)

scott.friesen@cwsaskatoon.com



FLOOR PLAN

FOR SUB LEASE | 2712 Wentz Avenue, Saskatoon SK

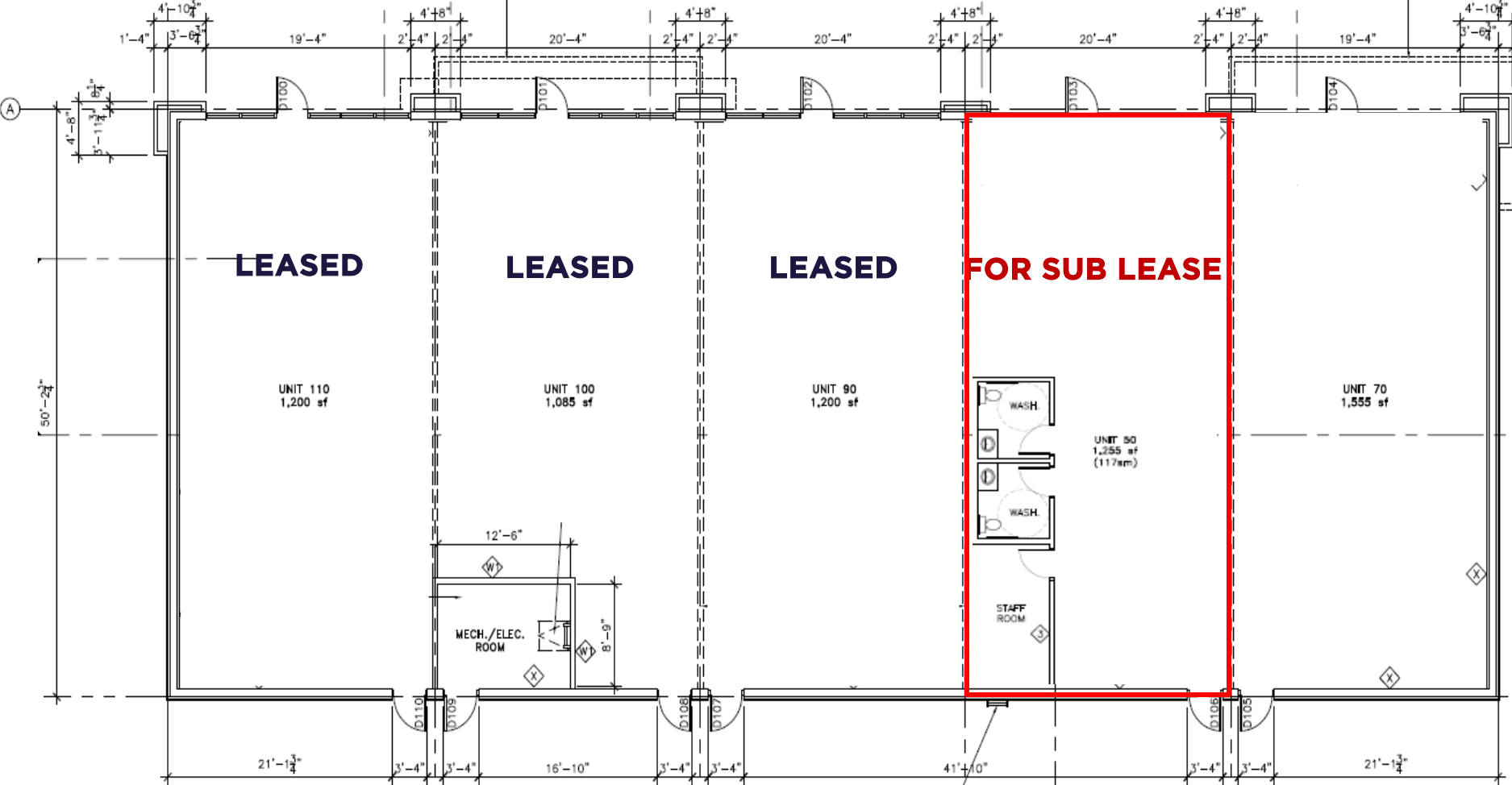

*Not to scale, not exactly as shown.

SITE PLAN

FOR SUB LEASE | 2712 Wentz Avenue, Saskatoon SK

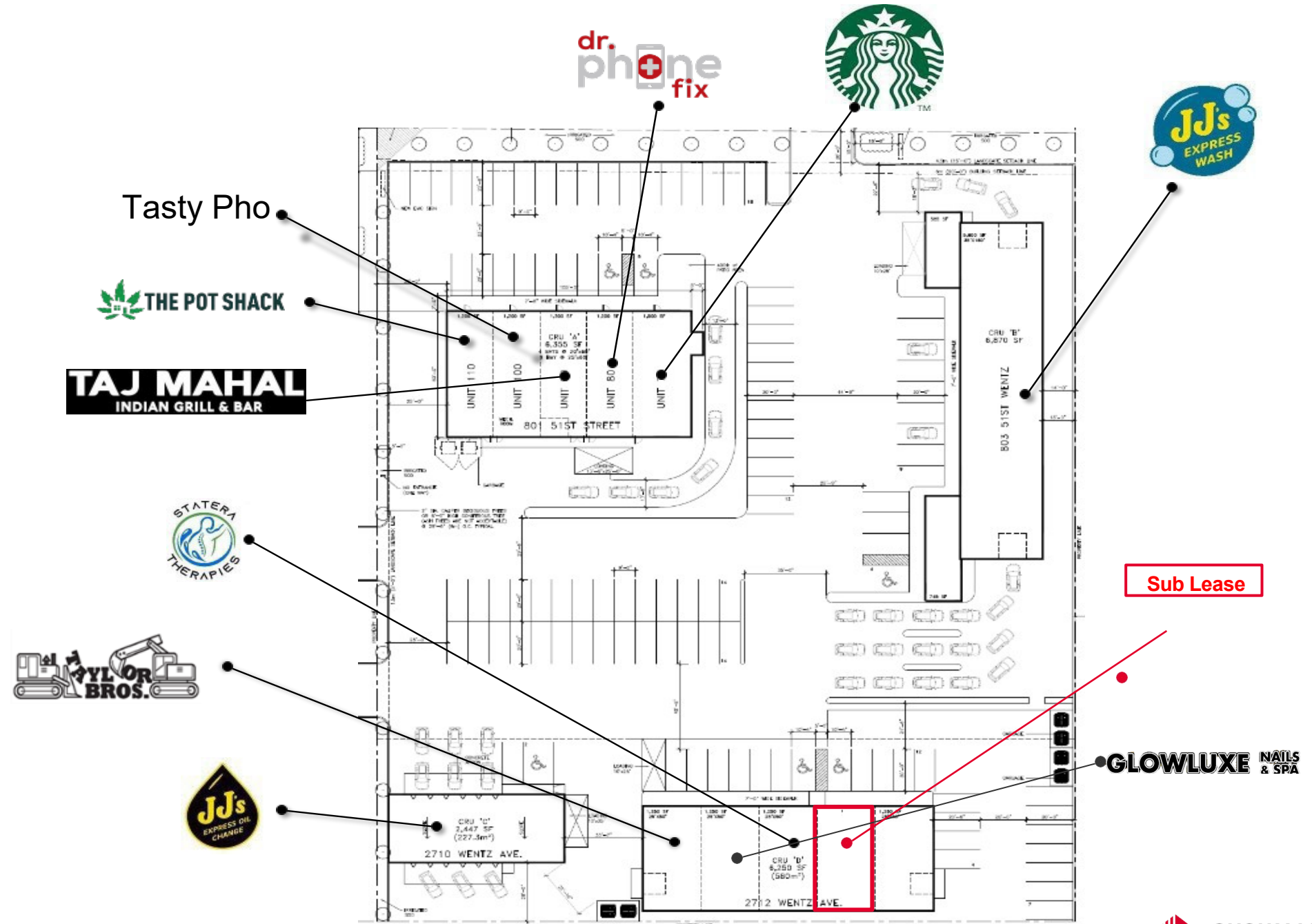

CRU PHOTOS

NORTH INDUSTRIAL

FOR SUB LEASE | 2712 Wentz Avenue, Saskatoon SK

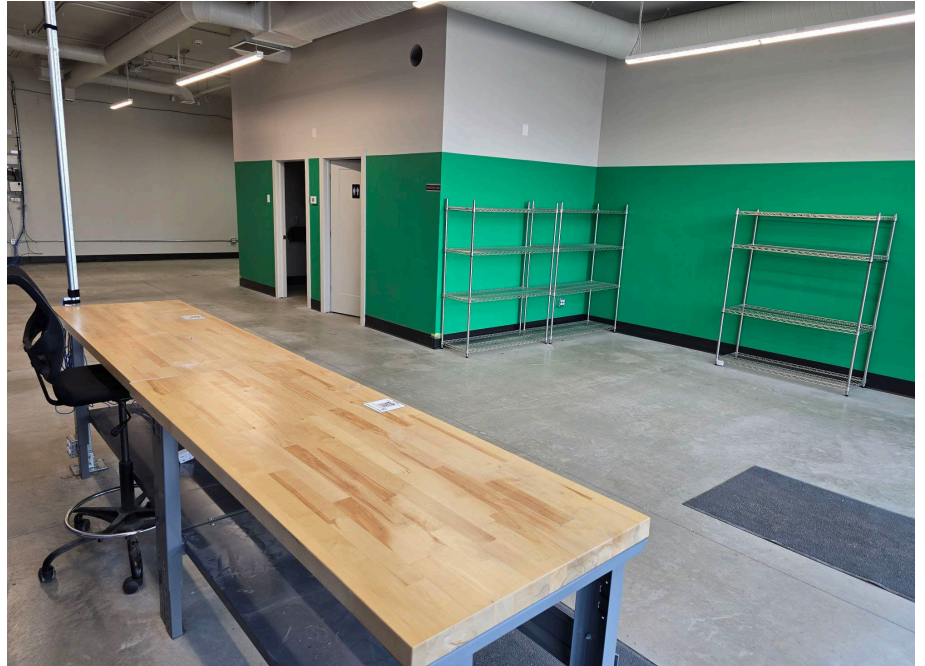

SITE PHOTOS

NORTH INDUSTRIAL

FOR SUB LEASE | 2712 Wentz Avenue, Saskatoon SK



LOCATION

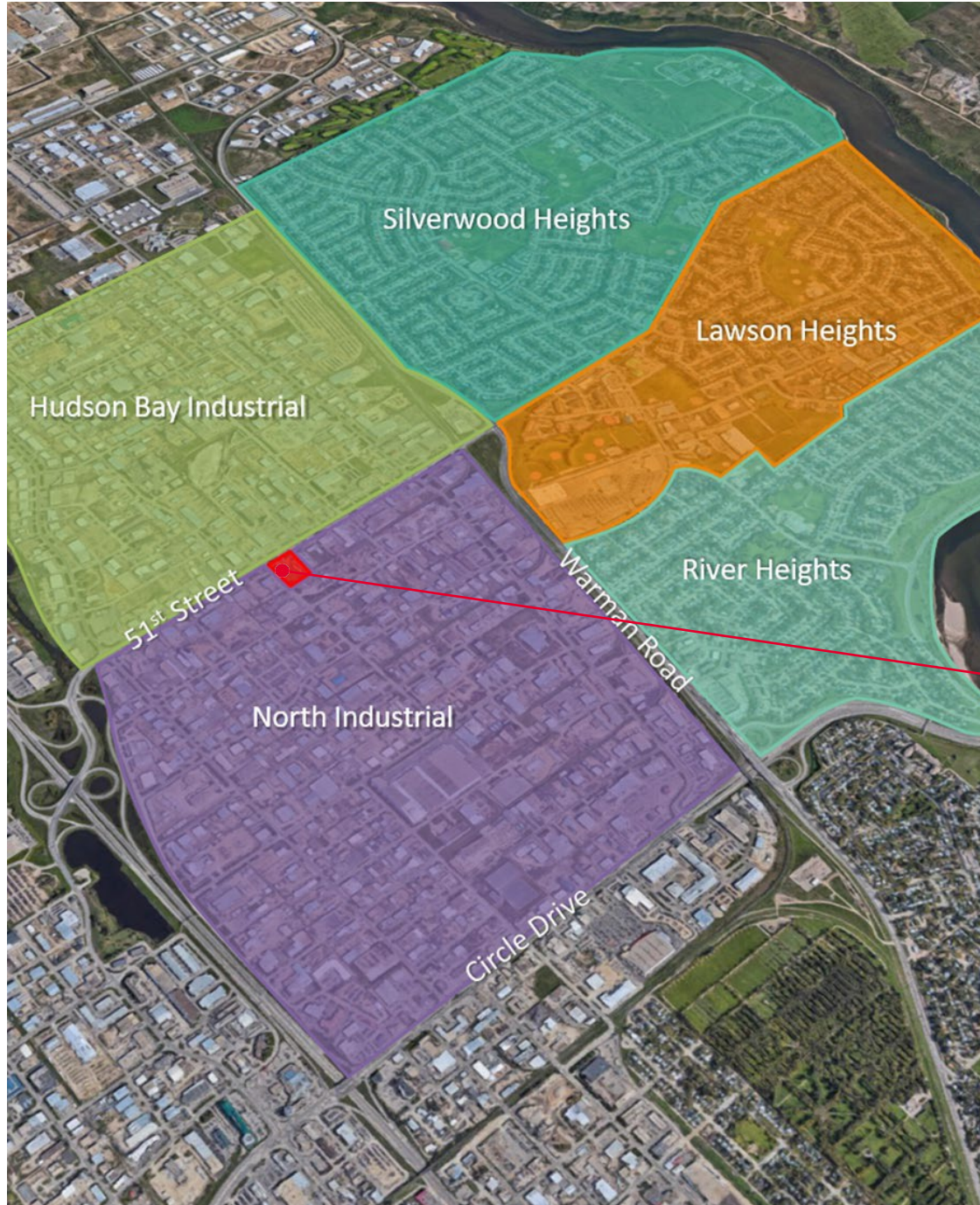

FOR SUB LEASE | 2712 Wentz Avenue, Saskatoon SK

Silverwood Heights

- Population: 8,678
- Household Income: \$104,789.00

Lawson Heights

- Population: 8,032
- Household Income: \$92,788.90

River Heights

- Population: 6,648
- Household Income: \$92,342.00





SCOTT FRIESEN

President / Broker

1-306-934-3377

scott.friesen@cwsaskatoon.com

MATT PRIEL

Senior Sales Associate

1-306-261-2375

matt.priel@cwsaskatoon.com

OFFICE

1-306-934-3377

info@cwsaskatoon.com

CUSHMAN & WAKEFIELD SASKATOON
A LOCAL FIRM WITH GLOBAL REACH

215-350 3rd Avenue North
Saskatoon, SK S7K 2J1
cushmanwakefieldsaskatoon.com

©2025 Cushman & Wakefield. All rights reserved. The information contained in this communication is strictly confidential. This information has been obtained from sources believed to be reliable but has not been verified. NO WARRANTY OR REPRESENTATION, EXPRESS OR IMPLIED, IS MADE AS TO THE CONDITION OF THE PROPERTY (OR PROPERTIES) REFERENCED HEREIN OR AS TO THE ACCURACY OR COMPLETENESS OF THE INFORMATION CONTAINED HEREIN, AND SAME IS SUBMITTED SUBJECT TO ERRORS, OMISSIONS, CHANGE OF PRICE, RENTAL OR OTHER CONDITIONS, WITHDRAWAL WITHOUT NOTICE, AND TO ANY SPECIAL LISTING CONDITIONS IMPOSED BY THE PROPERTY OWNER(S). ANY PROJECTIONS, OPINIONS OR ESTIMATES ARE SUBJECT TO UNCERTAINTY AND DO NOT SIGNIFY CURRENT OR FUTURE PROPERTY PERFORMANCE.